

- No tools required to couple and uncouple.
- Bi-directional flow design.
- Versatile options of both-end shutoff (DV), single-end shutoff (SV), and both end open (DF Series).

- DQ Series Quick Connector : 1 to 5 page
- DQM Series Miniature Quick Connector : 6 page
- DF Series Full Flow Quick Connector : 7 to 8 page
- DQPM PTFE Sealed Quick Connect : 9 to 14 page

DQ Series Quick Connectors



Features

- Bi-directional flow design.
- Simple to operate.
- SS316 construction with standard FKM O-ring.
- Brass construction with standard NBR O-ring.
- No tools required to couple and uncouple.
- Compact and light-weight design.

Operation

- Coupling
 1. Align the stem with the body in the identical Series.
 2. Push the stem into the body until it clicks.
- Uncoupling
 1. Pull the body sleeve toward stem.
 2. Remove stem from body.
- Do not couple or uncouple at pressures exceeding 250 psig (17.2 bar).

SV: Single valve coupled

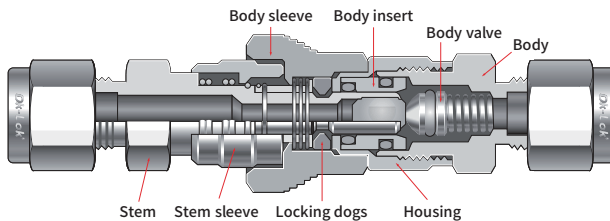

← **Bi-Directional Flow** →
Stem has no valve

DV: Double valve coupled

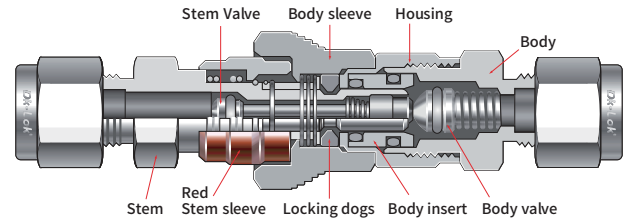

← **Bi-Directional Flow** →
Stem has valve

Materials of Construction

Component	Material	
	SS316	Brass
Body, Housing Body valve Body insert Body sleeve	SS316/ ASTM A276	JIS H3250 C3604
Locking dogs	Xylan™-coated SS316 powered	
Stem Stem sleeve Stem valve	SS316 / ASTM A276	JIS H3250 C3604
O-rings	FKM	NBR
Springs	SS302/ASTM A313	
Lubricants	Silicon and TFE based	

Wetted parts indicated in blue.

Pressure-Temperature Ratings

DQ Stem and Body	SS316 FKM O-rings			Brass NBR O-rings		
	DQA	DQB	DQC	DQA	DQB	DQC
	psi (bar) @ °F (°C)					
Coupled	3000 (206) @ 70 (21)	1500 (103) @ 70 (21)	750 (51.6) @ 70 (21)	2000 (137) @ 70 (21)	1000 (68.9) @ 70 (21)	500 (34.4) @ 70 (21)
	250 (17.2) @ 400 (204)			250 (17.2) @ 250 (121)		
Uncoupled	250 (17.2) @ 70 (21)					
When coupling and uncoupling	250 (17.2) @ 70 (21)					

Spillage and Air Inclusion

- Spillage is the volume of system fluid that escapes while a quick connector is uncoupled.
- Air inclusion is the volume of air trapped that comes in while a quick connector is coupled.

DQ Series	Spillage	Air Inclusion
DQ A	0.3	0.3
DQ B	1.0	1.0
DQ C	3.0	3.0

Ordering Information and Dimensions Stems

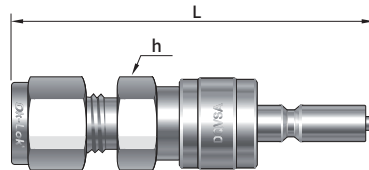

DV : Stem has a valve
SV : Stem has no valve

Series	End Connection	Basic Ordering Number		Cv			L mm (in.)		h Hex. in.
		SV	DV	SV	DV	Full Flow	SV	DV	
DQA	1/8 in. DK-Lok	DQSA-D-2T-	DQVSA-D-2T-	0.08	0.08	0.08	58.9 (2.32)	70.4 (2.77)	5/8
	1/4 in. DK-Lok	DQSA-D-4T-	DQVSA-D-4T-	0.3	0.2	0.4	59.9 (2.36)	61.5 (2.42)	5/8
	6 mm DK-Lok	DQSA-D-6M-	DQVSA-D-6M-	0.3	0.2	0.4	59.9 (2.36)	61.5 (2.42)	5/8
	1/8 in. Male NPT	DQSA-M-2N-	DQVSA-M-2N-	0.3	0.2	0.4	52.6 (2.07)	54.1 (2.13)	5/8
	1/4 in. Male NPT	DQSA-M-4N-	DQVSA-M-4N-	0.3	0.2	0.4	56.4 (2.22)	57.9 (2.28)	5/8
	1/8 in. Female NPT	DQSA-F-2N-	DQVSA-F-2N-	0.3	0.2	0.4	51.1 (2.01)	52.6 (2.07)	5/8
	1/4 in. Female NPT	DQSA-F-4N-	DQVSA-F-4N-	0.3	0.2	0.4	57.4 (2.26)	58.9 (2.32)	3/4
DQB	3/8 in. DK-Lok	DQSB-D-6T-	DQVSB-D-6T-	1.0	0.5	1.5	64.0 (2.52)	67.1 (2.64)	3/4
	10 mm DK-Lok	DQSB-D-10M-	DQVSB-D-10M-	1.0	0.5	1.5	67.3 (2.65)	70.4 (2.77)	3/4
	1/4 in. Male NPT	DQSB-M-4N-	DQVSB-M-4N-	0.9	0.5	1.5	58.9 (2.32)	61.9 (2.44)	3/4
	3/8 in. Male NPT	DQSB-M-6N-	DQVSB-M-6N-	0.8	0.5	1.6	59.7 (2.35)	62.7 (2.47)	3/4
	1/4 in. Female NPT	DQSB-F-4N-	DQVSB-F-4N-	0.9	0.5	1.5	59.7 (2.35)	62.7 (2.47)	3/4
	3/8 in. Female NPT	DQSB-F-6N-	DQVSB-F-6N-	0.8	0.5	1.6	59.7 (2.35)	62.7 (2.47)	7/8
DQC	1/2 in. DK-Lok	DQSC-D-8T-	DQVSC-D-8T-	2.4	1.5	3.3	75.2 (2.96)	80.3 (3.16)	15/16
	12 mm DK-Lok	DQSC-D-12M-	DQVSC-D-12M-	2.4	1.5	3.3	75.2 (2.96)	60.3 (3.16)	15/16
	1/2 in. Male NPT	DQSC-M-8N-	DQVSC-M-8N-	2.0	1.3	3.1	72.1 (2.84)	77.2 (3.04)	15/16
	1/2 in. Female NPT	DQSC-F-8N-	DQVSC-F-8N-	2.0	1.3	3.1	71.6 (2.82)	76.7 (3.02)	11/16

Stems-Bulkhead

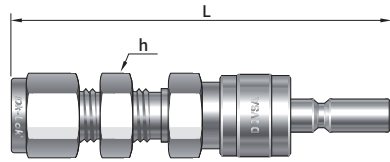

DV : Stem has a valve
SV : Stem has no valve

Series	End Connection	Basic Ordering Number		Panel Thickness Max. mm (in.)	Panel Hole Dia. Min. mm (in.)	L mm (in.)		h Hex. in.
		SV	DV			SV	DV	
DQA	1/4 in. DK-Lok	DQSA-BH-D-4T-	DQVSA-BH-D-4T-	6.4 (0.25)	11.9 (15/32)	69.6 (2.74)	71.1 (2.80)	5/8
	6 mm DK-Lok	DQSA-BH-D-6M-	DQVSA-BH-D-6M-	6.4 (0.25)	11.5 (29.64)	69.6 (2.74)	71.1 (2.80)	16 mm
DQB	3/8 in. DK-Lok	DQSB-BH-D-6T-	DQVSB-BH-D-6T-	6.9 (0.27)	15.1 (19/32)	74.2 (2.92)	76.0 (3.07)	3/4
	10 mm DK-Lok	DQSB-BH-D-10M-	DQVSB-BH-D-10M-	6.9 (0.27)	16.7 (21/32)	77.7 (3.06)	78.7 (3.10)	22 mm
DQC	1/2 in. DK-Lok	DQSC-BH-D-8T-	DQVSC-BH-D-8T-	6.6 (0.26)	19.8 (25/32)	87.1 (3.43)	92.2 (3.63)	15/16
	12 mm DK-Lok	DQSC-BH-D-12M-	DQVSC-BH-D-12M-	6.6 (0.26)	19.4 (49/64)	87.1 (3.43)	92.2 (3.63)	24 mm

Insertion depth and Overall length

To have an overall length in coupled position, subtract the insertion depth from the combination length of the stem and the body.

Insertion Depth

DQ Series	Depth mm (in.)	
	SV	DV
DQA	27.7 (1.09)	29.2 (1.15)
DQB	30.0 (1.18)	33.0 (1.30)
DQC	37.6 (1.48)	42.7 (1.68)

Bodies

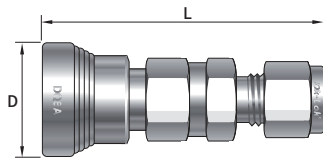

Series	End Connection	Basic Ordering Number	L mm (in.)	D mm (in.)
DQA	1/8 in. DK-Lok	DQBA-D-2T-	57.4 (2.26)	23.1 (0.91)
	1/4 in. DK-Lok	DQBA-D-4T-	56.4 (2.30)	23.1 (0.91)
	6 mm DK-Lok	DQBA-D-6M-	58.4 (2.30)	23.1 (0.91)
	1/8 in. Male NPT	DQBA-M-2N-	51.1 (2.01)	23.1 (0.91)
	1/4 in. Male NPT	DQBA-M-4N-	54.9 (2.16)	23.1 (0.91)
	1/4 in. Male ISO	DQBA-M-4R-	54.9 (2.16)	23.1 (0.91)
	1/8 in. Female NPT	DQBA-F-2N-	54.9 (2.16)	23.1 (0.91)
	1/4 in. Female NPT	DQBA-F-4N-	61.5 (2.42)	23.1 (0.91)
	1/4 in. Female ISO	DQBA-F-4R-	61.5 (2.42)	23.1 (0.91)
DQB	3/8 in. DK-Lok	DQBB-D-6T-	65.5 (2.58)	26.2 (1.03)
	10 mm DK-Lok	DQBB-D-10M-	68.1 (2.68)	26.2 (1.03)
	1/4 in. Male NPT	DQBB-M-4N-	60.5 (2.38)	26.2 (1.03)
	3/8 in. Male NPT	DQBB-M-6N-	60.5 (2.38)	26.2 (1.03)
	3/8 in. Male ISO	DQBB-M-6R-	60.5 (2.38)	26.2 (1.03)
	1/4 in. Female NPT	DQBB-F-4N-	64.5 (2.54)	26.2 (1.03)
	3/8 in. Female NPT	DQBB-F-6N-	65.3 (2.57)	26.2 (1.03)
	3/8 in. Female ISO	DQBB-F-6R-	65.3 (2.57)	26.2 (1.03)
	DQC	1/2 in. DK-Lok	DQBC-D-8T-	78.5 (3.09)
12 mm DK-Lok		DQBC-D-12M-	78.5 (3.09)	30.7 (1.21)
1/2 in. Male NPT		DQBC-M-8N-	75.4 (2.97)	30.7 (1.21)
1/2 in. Male ISO		DQBC-M-8R-	75.4 (2.97)	30.7 (1.21)
1/2 in. Female NPT		DQBC-F-8N-	81.8 (3.22)	30.7 (1.21)
1/2 in. Female ISO		DQBC-F-8R-	81.8 (3.22)	30.7 (1.21)

IDK-LOK® Quick Connectors

Bodies-Bulkhead

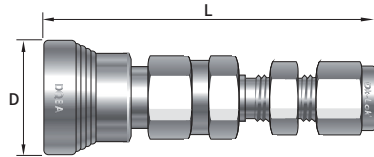

Series	End Connection	Basic Ordering Number	Panel Thickness Max.	Panel Hole Dia. Min.	L	D
			mm (in.)			
DQA	1/4 in. DK-Lok	DQBA-BH-D-4T-	6.4 (0.25)	11.9 (15/32)	67.8 (2.67)	23.1 (0.91)
	6 mm DK-Lok	DQBA-BH-D-6M-	6.4 (0.25)	11.9 (15/32)	67.8 (2.67)	23.1 (0.91)
DQB	3/8 in. DK-Lok	DQBB-BH-D-6T-	6.9 (0.27)	15.1 (19/32)	75.7 (2.98)	26.2 (1.03)
	10 mm DK-Lok	DQBB-BH-D-10M-	6.9 (0.27)	16.7 (21/32)	75.9 (2.99)	26.2 (1.03)
DQC	1/2 in. DK-Lok	DQBC-BH-D-8T-	6.6 (0.26)	19.8 (25/32)	90.4 (3.56)	30.7 (1.21)
	12 mm DK-Lok	DQBC-BH-D-12M-	6.6 (0.26)	19.4 (49/64)	90.4 (3.56)	30.7 (1.21)

How to Order

Add "SA" for SS316 or "BA" for Brass as a suffix to the Basic Ordering Number.

Examples : DQSA-D-4T-SA, DQBA-D-4T-BA.

O-ring Designators

<p>Nil : Standard FKM for SS316 quick connector Nil : Standard NBR for Brass quick connector FKM : VT NBR : BN FFKM : KZ EPDM : EP</p>	<p>How to Order an Optional O-ring Connector Insert O-ring designator to the basic ordering number. Examples: DQVSA-D-2T-KZ-SA, DQVSA-D-2T-EP-BA</p>
---	---

How to Order a Full Flow DQ Series Connector

A full flow DQ series consists of a SV stem and a full flow body.

To order a full flow body, select an applicable Basic Ordering Number, add "FF" and a material designator.

Examples : DQBA-D-4T-FF-SA, DQBB-D-6T-FF-SA.

Options

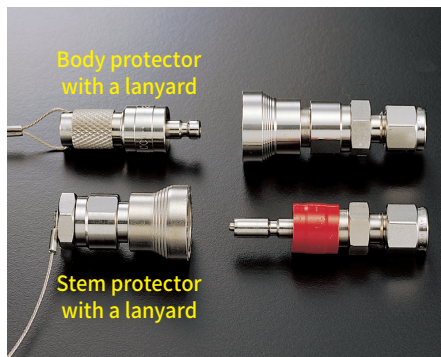

DQ Protectors

Body and Stem Protector are available to protect body and stem from damage and contamination while they are uncoupled.

Field Assembly Protector Ordering Number

Stem Protector	Body Protector
DQSA-CP-	DQBA-PG-
DQSB-CP-	DQBB-PG-
DQSC-CP-	DQBC-PG-

To complete ordering number, add a material designator "SA" for SS316, "BA" for Brass as a suffix to the protector ordering number.

Examples : DQSA-CP-SA, DQBA-PG-BA

Note : Stem Protector is applicable to both SV stem and DV stem.

Pressure Retaining Protectors

DQ Protectors are not pressure retaining devices.

To order the pressure retaining protector, add "P" as a suffix to the protector ordering number.

Examples : DQSA-CP-P, DQBA-PG-P.

Materials of Construction

Protector: Stainless steel or Brass

Lanyard: Stainless steel

Lanyard clamp: Stainless steel

How to order FACTORY ASSEMBLED PROTECTOR on to DQ stem and body.

Select an applicable STEM or BODY ordering number, and insert "CP" or "PG" in the ordering number.

Examples : DQVSC-D-12M-CP-SA, DQBC-D-12M-PG-SA.

DQ color coded “Keyed” quick connectors



Features

- DQ Keyed quick connectors prevent intermixing of different keys mechanically as well as allow visual identification by color coding.
- Eight (8) different keys on each DQ series are available with its own Key number.
- DQ keys are useful to control multi-fluid or multi-pressure systems.

Operation

- Select stem and body keyed in the same DQ series.
- Coupling : Align stem with body. Push stem into body until it clicks.
- Uncoupling : Pull body sleeve toward stem. Remove stem.

DQ Key Ordering Numbers and Sleeve Outside Diameter

Key Number	Key Color	DQA				DQB				DQC			
		Body Sleeve		Stem Sleeve		Body Sleeve		Stem Sleeve		Body Sleeve		Stem Sleeve	
		mm	inch	mm	inch	mm	inch	mm	inch	mm	inch	mm	inch
K1	Black	24.5	0.96	20.9	0.82	28.7	1.13	25.1	0.99	32.0	1.26	27.9	1.10
K2	Orange	25.0	0.99	21.6	0.85	29.5	1.16	25.8	1.02	32.8	1.29	28.9	1.14
K3	Green	26.0	1.02	22.4	0.88	30.2	1.19	26.6	1.05	33.6	1.32	29.7	1.17
K4	Yellow	26.8	1.05	23.2	0.91	31.0	1.22	27.4	1.08	34.3	1.35	30.4	1.20
K5	Blue	27.5	1.08	23.9	0.94	31.5	1.24	28.1	1.11	35.1	1.38	31.2	1.23
K6	White	28.3	1.11	24.7	0.97	32.5	1.28	28.9	1.14	35.8	1.41	32.0	1.26
K7	Purple	29.1	1.14	25.4	1.00	33.3	1.31	29.7	1.17	36.6	1.44	32.7	1.29
K8	Brown	29.8	1.17	26.2	1.03	34.0	1.34	30.4	1.20	37.4	1.47	33.5	1.32
Standard DQ Body Sleeve Dia.		23.1	0.91			26.2	1.03			30.7	1.21		

How to Order

Add the Key number as a suffix to the DQ series Ordering Number.

Examples : DQSB-D-6T-K1-SA.

DQM Series Miniature Quick Connectors

Features

- Bi-directional flow design.
- Miniature design for max. 4000 psi working pressure.
- Stainless steel and brass construction.
- **Operation** : To couple, to uncouple, pull body sleeve toward body.

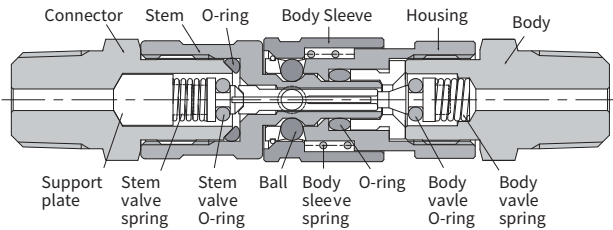

← Bi-Directional Flow →

Materials of Construction

Component	Material	
	Stainless	Brass
Body, Housing, Stem, Connector, Body sleeve	SS316/ ASTM A276	JIS H3250 C3604
Support plate, Left & Right fin	Stainless Steel	
Body valve, Stem valve	SS316/ ASTM A276	
Springs	SS302/ASTM A313	
O-rings	FKM	NBR
Locking ball	SS316	
Lubricants	Silicon and TFE based	

Wetted parts indicated in blue.

Ordering Information and Dimensions

Stems

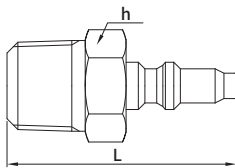

SV : Stem has no valve

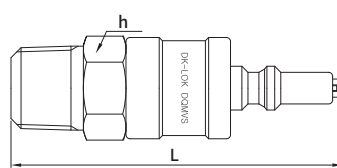

DV : Stem has a valve



End Connection	Basic Ordering Number		Cv			L mm (in.)		h Hex. in.
	SV	DV	SV	DV	Full Flow	SV	DV	
1/16 in. DK-Lok	DQMS-D-1T-	DQMVS-D-1T-	0.06	0.05	0.06	30.0 (1.18)	44.7 (1.76)	7/16
1/16 in. Male NPT	DQMS-M-1N-	DQMVS-M-1N-	0.06	0.05	0.06	26.2 (1.03)	40.9 (1.61)	7/16
1/16 in. Female NPT	DQMS-F-1N-	DQMVS-F-1N-	0.06	0.05	0.06	26.2 (1.03)	40.9 (1.61)	7/16
1/8 in. DK-Lok	DQMS-D-2T-	DQMVS-D-2T-	0.06	0.05	0.06	32.8 (1.29)	47.5 (1.87)	7/16
1/8 in. Male NPT	DQMS-M-2N-	DQMVS-M-2N-	0.06	0.05	0.06	26.2 (1.03)	40.9 (1.61)	7/16
1/8 in. Female NPT	DQMS-F-2N-	DQMVS-F-2N-	0.06	0.05	0.06	26.2 (1.03)	46.0 (1.81)	9/16

Body

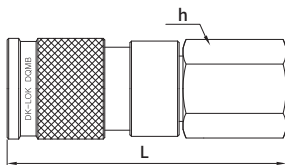

Basic Ordering Number	End Connection	L mm (in.)	h Hex. in.
DQMB-D-1T-	1/16 in. DK-Lok	38.1 (1.50)	7/16
DQMB-D-2T-	1/8 in. DK-Lok	43.2 (1.70)	7/16
DQMB-M-1N-	1/16 in. Male NPT	36.1 (1.42)	7/16
DQMB-M-2N-	1/8 in. Male NPT	36.6 (1.44)	7/16
DQMB-F-1N-	1/16 in. Female NPT	36.3 (1.43)	7/16
DQMB-F-2N-	1/8 in. Female NPT	41.1 (1.62)	9/16
DQMB-BH* -D-2T-	1/8 in. DK-Lok	53.1 (2.09)	7/16

* BH : Bulkhead

How to Order a Full Flow DQM Quick Connector

A full flow DQM series consists of a SV stem a full flow body.

To order a full flow body, select an applicable basic ordering number, add "FF" and a material designator.

i.e., DQMB-D-2T-FF-SA

Pressure- Temperature Ratings

DQM Stem and Body	SS316 FKM O-rings	Brass NBR O-rings
	Pressure Rating psi (bar) @ °F (°C)	
Coupled	4000 (275) @ 70 (21)	2000 (137) @ 70 (21)
	100 (6.8) @ 400 (204)	100 (6.8) @ 250 (121)
Uncoupled	100 (6.8) @ 70 (21)	
When coupling & uncoupling	100 (6.8) @ 70 (21)	

Spillage and Air Inclusion Insertion Depth

0.1cm³
 SV : 11.9 mm (0.47 in.)
 DV : 13.5 mm (0.53 in.)

Operation : To couple, to uncouple, pull body sleeve.

Insertion depth and Overall length

To have an overall length in coupled position, subtract the insertion depth from the combination length of the stem and the body.

How to Order

Add "SA" for SS316 or "BA" for brass as a suffix to the basic ordering number. Example : DQMS-D-1T-SA.

DF Series Full Flow Quick Connectors

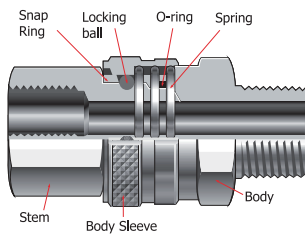

Features

- Bi-directional flow design.
- Applicable to maximum flow.
- Lowest pressure drop.
- No tools required to connect & disconnect.

Materials of Construction

Component	Materials	
	SS316	Brass
Body, Stem	SS316/ASTM A276	JIS H3250 C3604
Sleeve		
Snap Ring	SS316	SS316
Spring, Locking Ball	Stainless Steel	
O-ring	FKM	NBR
Lubricant	Silicon-based and PTFE-based lubricants	

Wetted parts and lubrication are indicated in blue.

Max. Pressure @ 70°F (21°C)

DF Series	SS316	Brass
	psig (bar)	
DFA	6000 (413)	4000 (275)
DFB		3000 (206)
DFC	4000 (275)	2000 (137)
DFD		

Max. Temperature Rating

DF Materials	O-ring Material	Max. Temp. Rating	Pressure Rating @ Max. Temp.
SS316	FKM	400 F (204°C)	100 psig (6.8 bar)
Brass	NBR	250 F (121°C)	100 psig (6.8 bar)

Cleaning and Packaging

Every connector is cleaned, and packed in a plastic sealing bag to keep them from dust, and then boxed for protection from damage during transportation and storage.

Operation

Coupling

1. Align stem with body.
2. Pull the body sleeve back.
3. Insert stem into body until it bottoms.
4. Return body sleeve to its original position.

Uncoupling

1. Pull the body sleeve back completely.
2. Remove stem from body.

Note :

Couple the identical Series of stem and body.

Caution : Do not uncouple under pressure.

Example: Any DFBA series body will fit any DFSA series stem.

Ordering Information and Dimensions

Stems

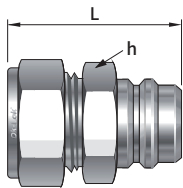

	Basic Ordering Number	End Connection	Cv	Orifice Min.	L	h
				mm (in.)		
DFSA-	D-4T-	1/4 in. DK-Lok	2.2	4.8 (0.19)	45.0 (1.77)	9/16
	D-6T-	3/8 in. DK-Lok	2.8	6.1 (0.24)	45.0 (1.77)	11/16
	D-6M-	6 mm DK-Lok	2.2	4.8 (0.19)	45.0 (1.77)	9/16
	M-4N-	1/4 in. Male NPT	1.7	6.1 (0.24)	40.4 (1.59)	9/16
	M-6N-	3/8 in. Male NPT	1.7	6.1 (0.24)	40.4 (1.59)	11/16
	F-4N-	1/4 in. Female NPT	1.7	6.1 (0.24)	40.6 (1.60)	3/4
DFSB-	F-6N-	3/8 in. Female NPT	1.7	6.1 (0.24)	42.4 (1.67)	7/8
	D-6T-	3/8 in. DK-Lok	2.9	7.1 (0.28)	47.8 (1.88)	7/8
	D-8T-	1/2 in. DK-Lok	13.0	10.4 (0.41)	50.5 (1.99)	7/8
	M-6N-	3/8 in. Male NPT	7.1	10.4 (0.41)	40.4 (1.59)	7/8
	M-8N-	1/2 in. Male NPT	11.5	12.7 (0.50)	46.7 (1.84)	7/8
	F-6N-	3/8 in. Female NPT	7.1	11.9 (0.47)	40.4 (1.59)	1 1/16
DFSC-	F-8N-	1/2 in. Female NPT	11.5	12.7 (0.50)	46.2 (1.82)	1 1/16
	D-12T-	3/4 in. DK-Lok	26.0	15.7 (0.62)	54.6 (2.15)	1 1/16
	M-12N-	3/4 in. Male NPT	23.6	18.3 (0.72)	51.6 (2.03)	1 1/16
DFSD-	F-12N-	3/4 in. Female NPT	23.6	18.3 (0.72)	52.8 (2.08)	1 5/16
	D-16T-	1 in. DK-Lok	45.0	22.4 (0.88)	62.2 (2.45)	1 3/8
	M-16N-	1 in. Male NPT	39.0	22.4 (0.88)	59.7 (2.35)	1 3/8
	F-16N-	1 in. Female NPT	39.0	22.4 (0.88)	63.2 (2.49)	1 5/8

Bodies

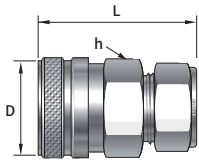

Basic Ordering Number	End Connection	Orifice Min.	L	D	h	
		mm (in.)				
DFBA-	D-4T-	1/4 in. DK-Lok	4.8 (0.19)	45.7 (1.80)	22.1 (0.87)	1 1/16
	D-6T-	3/8 in. DK-Lok	7.1 (0.28)	46.0 (1.81)	22.1 (0.87)	1 1/16
	D-6M-	6 mm DK-Lok	4.8 (0.19)	45.7 (1.80)	22.1 (0.87)	11/16
	M-4N-	1/4 in. Male NPT	6.4 (0.25)	39.9 (1.57)	22.1 (0.87)	11/16
	M-6N-	3/8 in. Male NPT	9.4 (0.37)	39.9 (1.57)	22.1 (0.87)	11/16
	F-4N-	1/4 in. Female NPT	9.7 (0.38)	38.1 (1.50)	22.1 (0.87)	3/4
	F-6N-	3/8 in. Female NPT	9.7 (0.38)	41.4 (1.63)	22.1 (0.87)	7/8
DFBB-	D-6T-	3/8 in. DK-Lok	7.1 (0.28)	55.1 (2.17)	33.0 (1.30)	1 1/16
	D-8T-	1/2 in. DK-Lok	11.9 (0.47)	56.6 (2.23)	33.0 (1.30)	1 1/16
	M-6N-	3/8 in. Male NPT	10.4 (0.41)	46.5 (1.83)	33.0 (1.30)	1 1/16
	M-8N-	1/2 in. Male NPT	12.7 (0.50)	52.8 (2.08)	33.0 (1.30)	1 1/16
	F-6N-	3/8 in. Female NPT	15.0 (0.59)	43.9 (1.73)	33.0 (1.30)	1 1/16
	F-8N-	1/2 in. Female NPT	16.0 (0.63)	43.9 (1.73)	33.0 (1.30)	1 1/16
DFBC-	D-12T-	3/4 in. DK-Lok	15.7 (0.62)	62.2 (2.45)	42.2 (1.66)	1 1/2
	M-12N-	3/4 in. Male NPT	18.3 (0.72)	59.2 (2.33)	42.2 (1.66)	1 1/2
	F-12N-	3/4 in. Female NPT	22.4 (0.88)	48.0 (1.89)	42.2 (1.66)	1 1/2
DFBD-	D-16T-	1 in. DK-Lok	22.4 (0.88)	69.9 (2.75)	47.8 (1.88)	1 11/16
	M-16N-	1 in. Male NPT	22.4 (0.88)	67.3 (2.65)	47.8 (1.88)	1 11/16
	F-16N-	1 in. Female NPT	26.9 (1.06)	53.8 (2.12)	47.8 (1.88)	1 11/16

DF Protectors

Body and Stem Protector are available to protect body and stem from damage and contamination while they are uncoupled.

Field Assembly Protector Ordering Number

Stem Protector	Body Protector
DFSA-CP-	DFBA-PG-
DFSB-CP-	DFBB-PG-
DFSC-CP-	DFBC-PG-
DFSD-CP-	DFBD-PG-

To complete ordering number, add a material designator "SA" for SS316, "BA" for Brass as a suffix to the protector ordering number.

Examples : DFSA-CP-SA, DFBA-PG-BA.

Insertion Depth

Unit : mm (in.)

DF Series	Depth
DFA	19.8 (0.78)
DFB	20.6 (0.81)
DFC	22.9 (0.90)
DFD	23.9 (0.94)

How to order FACTORY ASSEMBLED PROTECTOR on to DF stem and body.

Select an applicable STEM or BODY ordering number, and insert "CP" or "PG" in the ordering number.

Examples : DFSA-D-4T-CP-SA, DFBA-D-4T-PG-SA

Safety Pin Option on DF series

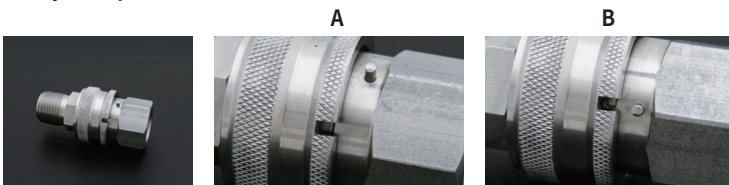

A. A safety pin on body with a holding groove on sleeve prevents accidental uncoupling.

B. To Uncouple, rotate body sleeve for the pin to fit into the groove and pull the body sleeve back.

To order Safety Pin DF body, insert "P" in the ordering number. Example: DFBC-D-12T-P-SA

All dimensions shown are for reference only and subject to change. Dimensions with DK-Lok Tube Fitting are finger-tight position. We reserve the right to change specification stated in this catalog for our continuing program of product improvement.

DQPM Series PTFE Sealed Quick Connect



Features

- Bi-directional flow design.
- Simple to operate.
- No tools required to couple and uncouple.
- Keyed option is available.
- Max working pressure : 4,500psi.
- Stainless steel and Monel 400 construction.

Operation

- Coupling
 1. Align the stem with the body in the identical Series.
 2. Push the stem into the body until it clicks.
- Uncoupling
 1. Pull the body sleeve toward stem.
 2. Remove stem from body.
- Do not couple or uncouple at pressures exceeding 250 psig (17.2 bar).

Note

Couple the identical Series of stem and body.
 Example : Any DQPM8 body will fit any DQPM8D(DV) or DQPM8S(SV) stem.

Materials of Construction

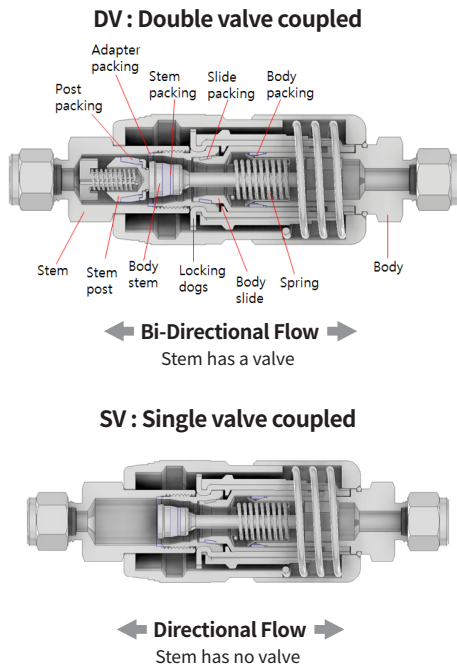

Component	Material	
	SS316	Alloy 400 / Monel
Valve body	SS316 / Xylan Coated	Alloy 400 / Xylan Coated
Stem body, Adapter Post, Post cap	SS316 / ASTM A276	Alloy 400 / ASTM B164
Body cap1, Body cap2		
Body Insert		
Slide, Body stem		
Body stem cap	SS316	Alloy 400
Stem Spring guide1		
Stem Spring guide2	SS304	Alloy 400
Body Locking dogs		
Body Locking bracket		
Slide spring guide1		
Slide spring guide2	TFM 1600	
Adapter packing		
Body packing		
Body backup packing	PTFE	
Slide packing		
Post packing	SS316 or Alloy X-750	Alloy X-750
Stem packing		
Slide spring		
Stem spring	SS304	Alloy X-750
Body cap spring		
Stem post ring		
Body cap ring		
Body Stem ring		

Wetted parts indicated in blue.

Pressure-Temperature Ratings

DQPM Stem and Body	SS316			Alloy 400
	DQPM2	DQPM4	DQPM8	DQPM2
	psi (bar)@°F (°C)			
Coupled	4500 (310) @ 0 ~ 194 (-17 ~ 90)	3200 (220) @ 0 ~ 194 (-17 ~ 90)	3200 (220) @ 0 ~ 194 (-17 ~ 90)	3200 (220) @ 0 ~ 120 (-17 ~ 48)
Uncoupled	1000 (68.9) @ 0 ~ 194 (-17 ~ 90)			1000 (68.9) @ 0 ~ 120 (-17 ~ 48)
When coupling and uncoupling	250 (17.2) @70(20)	100 (6.8) @70(20)	50 (3.4) @70(20)	250 (17.2) @70(20)

Spillage and Air Inclusion (DV Only)

Series	Spillage	Air Inclusion
DQPM2	0.1	0.1
DQPM4	0.2	0.4
DQPM8	1.0	2.0

- Spillage is the volume of system fluid that escapes while a quick connect is uncoupled.
- Air inclusion is the volume of air trapped that comes in while a quick connect is coupled.

Ordering Information and Dimensions

Bodies

DK-Lok Tube Fitting

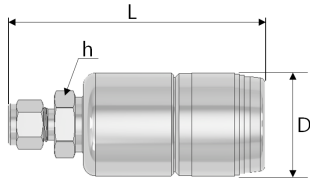

Series	End Connection	Basic Ordering Number	D mm (in.)	L mm (in.)	h Hex. In
DK-Lok Tube Fitting					
DQPM2	1/4 in. DK-Lok	DQPM2-D4T	28.4 (1.12)	80.3 (3.16)	5/8
	3/8 in. DK-Lok	DQPM2-D6T	28.4 (1.12)	82.6 (3.25)	11/16
	6 mm DK-Lok	DQPM2-D6M	28.4 (1.12)	80.3 (3.16)	15mm
DQPM4	8 mm DK-Lok	DQPM2-D8M	28.4 (1.12)	80.3 (3.16)	15mm
	1/4 in. DK-Lok	DQPM4-D4T	44.0 (1.73)	104.0 (4.08)	15/16
	3/8 in. DK-Lok	DQPM4-D6T	44.0 (1.73)	104.0 (4.08)	15/16
DQPM8	6 mm DK-Lok	DQPM4-D6M	44.0 (1.73)	104.0 (4.08)	24mm
	10 mm DK-Lok	DQPM4-D10M	44.0 (1.73)	104.0 (4.08)	24mm
	1/2 in. DK-Lok	DQPM8-D8T	50.8 (4.30)	109.0 (4.30)	1-1/4
	3/4 in. DK-Lok	DQPM8-D12T	50.8 (4.30)	109.0 (4.30)	1-1/4
DQPM8	1 in. DK-Lok	DQPM8-D16T	50.8 (4.30)	116.0 (4.58)	1-3/8
	12 mm DK-Lok	DQPM8-D12M	50.8 (4.30)	109.0 (4.30)	32mm

Male NPT / BSPT

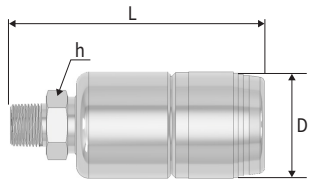

Series	End Connection	Basic Ordering Number	D mm (in.)	L mm (in.)	h Hex. In
Male NPT					
DQPM2	1/4 in. Male NPT	DQPM2-M4N	28.4 (1.12)	76.7 (3.02)	5/8
	3/8 in. Male NPT	DQPM2-M6N	28.4 (1.12)	78.0 (3.07)	3/4
DQPM4	1/4 in. Male NPT	DQPM4-M4N	44.0 (1.73)	98.9 (3.89)	15/16
	3/8 in. Male NPT	DQPM4-M6N	44.0 (1.73)	98.9 (3.89)	15/16
DQPM8	1/2 in. Male NPT	DQPM8-M8N	50.8 (4.30)	109.0 (4.30)	1-1/4
	3/4 in. Male NPT	DQPM8-M12N	50.8 (4.30)	109.0 (4.30)	1-1/4
	1 in. Male NPT	DQPM8-M16N	50.8 (4.30)	116.0 (4.58)	1-3/8
ISO Tapered Male BSPT					
DQPM2	1/4 in. Male PT	DQPM2-M4R	28.4 (1.12)	76.7 (3.02)	5/8
	3/8 in. Male PT	DQPM2-M6R	28.4 (1.12)	78.0 (3.07)	3/4
DQPM4	1/4 in. Male PT	DQPM4-M4R	44.0 (1.73)	98.9 (3.89)	15/16
	3/8 in. Male PT	DQPM4-M6R	44.0 (1.73)	98.9 (3.89)	15/16
DQPM8	1/2 in. Male PT	DQPM8-M8R	50.8 (4.30)	109.0 (4.30)	1-1/4
	3/4 in. Male PT	DQPM8-M12R	50.8 (4.30)	109.0 (4.30)	1-1/4
	1 in. Male PT	DQPM8-M16R	50.8 (4.30)	116.0 (4.58)	1-3/8

Male BSPP

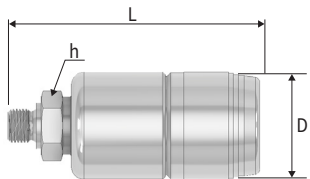

Series	End Connection	Basic Ordering Number	D mm (in.)	L mm (in.)	h Hex. In
ISO Parallel Male BSPP					
DQPM2	1/4 in. Male PF	DQPM2-M4G	28.4 (1.12)	76.7 (3.02)	3/4
DQPM4	1/4 in. Male PF	DQPM4-M4G	44.0 (1.73)	98.9 (3.89)	15/16
DQPM8	1/2 in. Male PF	DQPM8-M8G	50.8 (4.30)	109.0 (4.30)	1-1/4

Male JIC 37°

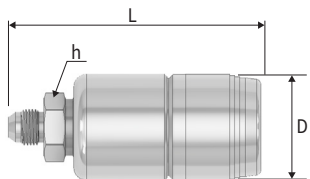

Series	End Connection	Basic Ordering Number	D mm (in.)	L mm (in.)	h Hex. In
JIC 37° Flare					
DQPM4	1/4 in. AN Flare	DQPM4-M4A	44.0 (1.73)	98.9 (3.89)	15/16
DQPM8	1/2 in. AN Flare	DQPM8-M8A	50.8 (4.30)	109.0 (4.30)	1-1/4

Ordering Information and Dimensions Bodies

Bodies

Female NPT / BSPT / BSPP

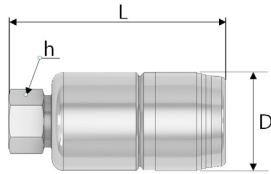

Series	End Connection	Basic Ordering Number	D mm (in.)	L mm (in.)	h Hex. In
Female NPT					
DQPM2	1/8 in. Female NPT	DQPM2-F2N	28.4 (1.12)	66.0 (2.60)	5/8
	1/4 in. Female NPT	DQPM2-F4N	28.4 (1.12)	75.9 (2.99)	3/4
DQPM4	3/8 in. Female NPT	DQPM2-F6N	28.4 (1.12)	77.2 (3.04)	3/4
	1/4 in. Female NPT	DQPM4-F4N	44.0 (1.73)	85.1 (3.35)	15/16
DQPM8	3/8 in. Female NPT	DQPM4-F6N	44.0 (1.73)	85.1 (3.35)	15/16
	1/2 in. Female NPT	DQPM8-F8N	50.8 (4.30)	89.7 (3.53)	1-1/4
	3/4 in. Female NPT	DQPM8-F12N	50.8 (4.30)	102.0 (4.02)	1-5/16
	1 in. Female NPT	DQPM8-F16N	50.8 (4.30)	112.0 (4.40)	1-5/8
ISO Tapered Female BSPT					
DQPM2	1/4 in. Female PT	DQPM2-F4R	28.4 (1.12)	75.9 (2.99)	3/4
DQPM4	1/4 in. Female PT	DQPM4-F4R	44.0 (1.73)	85.1 (3.35)	15/16
DQPM8	1/2 in. Female PT	DQPM8-F8R	50.8 (4.30)	89.7 (3.53)	1-1/4
ISO Parallel Female BSPP					
DQPM2	1/8 in. Female PF	DQPM2-F2G	28.4 (1.12)	66.0 (2.60)	5/8
	1/4 in. Female PF	DQPM2-F4G	28.4 (1.12)	75.9 (2.99)	3/4
DQPM4	1/4 in. Female PF	DQPM4-F4G	44.0 (1.73)	85.1 (3.35)	15/16
DQPM8	1/2 in. Female PF	DQPM8-F8G	50.8 (4.30)	89.7 (3.53)	1-1/4

Bulkhead Bodies

DK-Lok Tube Fitting

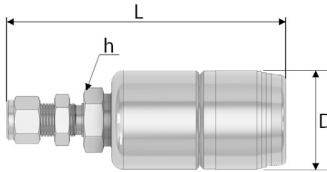

Integral Bulkhead

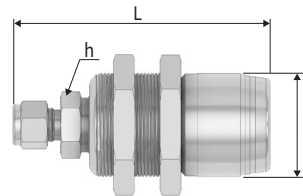

Series	End Connection	Basic Ordering Number	D mm (in.)	L mm (in.)	h Hex. In	Panel Hole Drill size mm (in.)	Panel Max Thickness mm (in.)
DK-Lok Tube Fitting							
DQPM2	1/4 in. DK-Lok	DQPM2-D4T-B	28.4 (1.12)	80.3 (3.16)	5/8	30.6 (1.20)	16.5 (0.65)
	6 mm DK-Lok	DQPM2-D6M-B	28.4 (1.12)	80.3 (3.16)	15mm	30.6 (1.20)	16.5 (0.65)
DQPM4	1/4 in. DK-Lok	DQPM4-D4T-B	44.0 (1.73)	119.0 (4.68)	15/16	11.7 (0.46)	3.8 (0.15)
	3/8 in. DK-Lok	DQPM4-D6T-B	44.0 (1.73)	122.0 (4.80)	15/16	14.7 (0.58)	3.8 (0.15)
	6 mm DK-Lok	DQPM4-D6M-B	44.0 (1.73)	119.0 (4.68)	24mm	11.7 (0.46)	3.8 (0.15)
DQPM8	10 mm DK-Lok	DQPM4-D10M-B	44.0 (1.73)	122.0 (4.80)	24mm	16.8 (0.66)	3.8 (0.15)
	1/2 in. DK-Lok	DQPM8-D8T-B	50.8 (4.30)	130.0 (5.11)	1-1/4	19.6 (0.77)	4.8 (0.19)
	12 mm DK-Lok	DQPM8-D12M-B	50.8 (4.30)	130.0 (5.11)	32mm	19.6 (0.77)	4.8 (0.19)

Insertion depth

To have an overall length in coupled position, subtract the insertion depth from the combination length of the stem and the body.

Series	Depth mm (in.)
DQPM2	0.9(23.5)
DQPM4	1.1(27.2)
DQPM8	1.2(30.6)

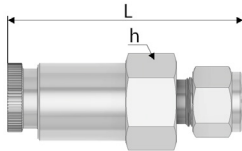
Ordering Information and Dimensions Stems
Stems
Dk-Lok Tube Fitting

SV : Stem has no valve
DV : Stem has a valve

Series	End Connection	Basic Ordering Number		Cv		L mm (in.)	h Hex. In
		SV	DV	SV	DV		
DK-Lok Tube Fitting							
DQPM2	1/4 in. DK-Lok	DQPM2S-D4T	DQPM2D-D4T	0.7	0.6	51.1 (2.01)	5/8
	3/8 in. DK-Lok	DQPM2S-D6T	DQPM2D-D6T	0.9	0.8	52.6 (2.07)	11/16
	6 mm DK-Lok	DQPM2S-D6M	DQPM2D-D6M	0.7	0.6	51.1 (2.01)	16mm
	8 mm DK-Lok	DQPM2S-D8M	DQPM2D-D8M	0.9	0.8	53.1 (2.09)	16mm
DQPM4	1/4 in. DK-Lok	DQPM4S-D4T	DQPM4D-D4T	0.9	0.8	66.3 (2.61)	15/16
	3/8 in. DK-Lok	DQPM4S-D6T	DQPM4D-D6T	1.7	1.6	67.8 (2.67)	15/16
	6 mm DK-Lok	DQPM4S-D6M	DQPM4D-D6M	0.9	0.8	66.3 (2.61)	5/8
	10 mm DK-Lok	DQPM4S-D10M	DQPM4D-D10M	1.7	1.6	68.1 (2.68)	24mm
DQPM8	1/2 in. DK-Lok	DQPM8S-D8T	DQPM8D-D8T	4.2	3.1	77.7 (3.06)	1-5/16
	3/4 in. DK-Lok	DQPM8S-D12T	DQPM8D-D12T	6.7	6.4	77.7 (3.06)	1-5/16
	1 in. DK-Lok	DQPM8S-D16T	DQPM8D-D16T	9.0	7.8	83.1 (3.27)	1-3/8
	12 mm DK-Lok	DQPM8S-D12M	DQPM8D-D12M	4.2	3.1	77.7 (3.06)	35mm

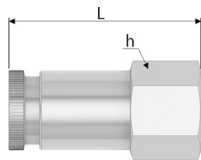
Female NPT / BSPT / BSPP

Series	End Connection	Basic Ordering Number		Cv		L mm (in.)	h Hex. In
		SV	DV	SV	DV		
Female NPT							
DQPM2	1/4 in. Female NPT	DQPM2S-F4N	DQPM2D-F4N	0.2	0.2	48.5 (1.91)	5/8
	3/8 in. Female NPT	DQPM2S-F6N	DQPM2D-F6N	0.7	0.6	51.8 (2.04)	11/16
DQPM4	1/4 in. Female NPT	DQPM4S-F4N	DQPM4D-F4N	1.4	1.4	62.5 (2.46)	15/16
	3/8 in. Female NPT	DQPM4S-F6N	DQPM4D-F6N	1.8	1.7	62.5 (2.46)	15/16
DQPM8	1/2 in. Female NPT	DQPM8S-F8N	DQPM8D-F8N	5.1	4.4	70.6 (2.78)	1-5/16
	3/4 in. Female NPT	DQPM8S-F12N	DQPM8D-F12N	8.5	7.8	70.6 (2.78)	1-5/16
	1 in. Female NPT	DQPM8S-F16N	DQPM8D-F16N	-	-	77.0 (3.03)	1-5/8
ISO Tapered Female BSPT							
DQPM2	1/4 in. Female PT	DQPM2S-F4R	DQPM2D-F4R	0.2	0.2	48.5 (1.91)	5/8
DQPM4	1/4 in. Female PT	DQPM4S-F4R	DQPM4D-F4R	1.4	1.4	62.5 (2.46)	15/16
DQPM8	1/2 in. Female PT	DQPM8S-F8R	DQPM8D-F8R	5.1	4.4	70.6 (2.78)	1-5/16
ISO Parallel Female BSPP							
DQPM2	1/8 in. Female PF	DQPM2S-F2G	DQPM2D-F2G	0.5	0.4	48.5 (1.91)	5/8
	1/4 in. Female PF	DQPM2S-F4G	DQPM2D-F4G	0.6	0.6	48.5 (1.91)	3/4
DQPM4	1/4 in. Female PF	DQPM4S-F4G	DQPM4D-F4G	1.2	1.2	63.0 (2.48)	15/16
DQPM8	1/2 in. Female PF	DQPM8S-F8G	DQPM8D-F8G	4.8	3.9	70.6 (2.78)	1-5/16

Ordering Information and Dimensions Stems

Stems

Male NPT / BSPT

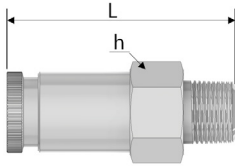

SV : Stem has no valve
DV : Stem has a valve

Series	End Connection	Basic Ordering Number		Cv		L mm (in.)	h Hex. In
		SV	DV	SV	DV		
Male NPT							
DQPM2	1/4 in. Male NPT	DQPM2S-M4N	DQPM2D-M4N	0.2	0.2	48.5 (1.91)	5/8
	3/8 in. Male NPT	DQPM2S-M6N	DQPM2D-M6N	0.7	0.6	51.8 (2.04)	11/16
DQPM4	1/4 in. Male NPT	DQPM4S-M4N	DQPM4D-M4N	1.4	1.4	62.5 (2.46)	15/16
	3/8 in. Male NPT	DQPM4S-M6N	DQPM4D-M6N	1.8	1.7	62.5 (2.46)	15/16
DQPM8	1/2 in. Male NPT	DQPM8S-M8N	DQPM8D-M8N	5.1	4.4	70.6 (2.78)	1-5/16
	3/4 in. Male NPT	DQPM8S-M12N	DQPM8D-M12N	8.5	7.8	70.6 (2.78)	1-5/16
	1 in. Male NPT	DQPM8S-M16N	DQPM8D-M16N	-	-	77.0 (3.03)	1-5/8
ISO Tapered Male BSPT							
DQPM2	1/4 in. Male PT	DQPM2S-M4R	DQPM2D-M4R	0.2	0.2	48.5 (1.91)	5/8
DQPM4	1/4 in. Male PT	DQPM4S-M4R	DQPM4D-M4R	1.4	1.4	62.5 (2.46)	15/16
DQPM8	1/2 in. Male PT	DQPM8S-M8R	DQPM8D-M8R	5.1	4.4	70.6 (2.78)	1-5/16

Male BSPP

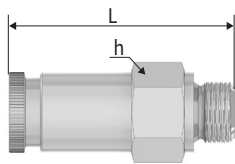

Series	End Connection	Basic Ordering Number		Cv		L mm (in.)	h Hex. In
		SV	DV	SV	DV		
ISO Parallel Male BSPP							
DQPM2	1/8 in. Male PF	DQPM2S-M2G	DQPM2D-M2G	0.5	0.4	48.5 (1.91)	5/8
	1/4 in. Male PF	DQPM2S-M4G	DQPM2D-M4G	0.6	0.6	48.5 (1.91)	3/4
DQPM4	1/4 in. Male PF	DQPM4S-M4G	DQPM4D-M4G	1.2	1.2	63.0 (2.48)	15/16
DQPM8	1/2 in. Male PF	DQPM8S-M8G	DQPM8D-M8G	4.8	3.9	70.6 (2.78)	1-5/16

Male JIC 37°

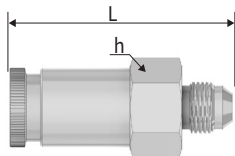

Series	End Connection	Basic Ordering Number		Cv		L mm (in.)	h Hex. In
		SV	DV	SV	DV		
Male JIC 37° Flare							
DQPM4	1/4 in. AN Flare	DQPM4S-M4A	DQPM4D-M4A	-	-	63.0 (2.48)	15/16
DQPM8	1/2 in. AN Flare	DQPM8S-M8A	DQPM8D-M8A	4.2	2.7	70.6 (2.78)	1-5/16

How to Order

DQPM series consists of a DV or SV stem and body

Examples : DQPM8D-D8T-S(DV) or DQPM8S-D8T-S(SV) and DQPM8-D8T-S(Body)

DQPM color coded “Keyed” quick connect

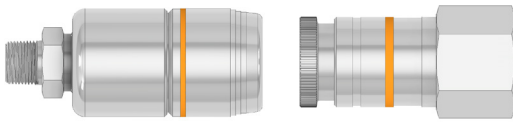

Key Color	Key Number and Designator
Black	K1
Orange	K2
Green	K3
Yellow	K4
Blue	K5
White	K6
Purple	K7
Brown	K8

Features

- DQPM Keyed quick connect prevent intermixing of different keys mechanically as well as allow visual identification by color coding.
- Eight (8) different keys on each DQPM series are available with its own Key number.
- DQPM keys are useful to control multi-fluid or multi-pressure systems.
- If an attempt is made to couple unlike keys, the valve system will not open.

Operation

- Select stem and body keyed in the same DQPM series.
- Coupling: Align stem with body. Push stem into body until it clicks.
- Uncoupling: Pull body sleeve toward stem. Remove stem.
- If an attempt is made to couple unlike keys, the valve system will no open.

How to Order

Add the key number as a suffix to the DQPM series Ordering Number.

Examples : DQPM8-D8T-K1-S, DQPM8D-D8T-K1-S

DQPM2 and DQPM4 series quick connect are available in keys K1 through K8.

DQPM8 series quick connects are available in keys K1 through K4 only.

All dimensions shown are for reference only and subject to change. Dimensions with DK-Lok Tube Fittings are in finger-tight position. We reserve the right to change specifications stated in this catalog for our continuing program of product improvement.

IDK-LOK®
www.dklok.com

IDK-LOK Corporation

Mailing Address

7, Golden root-ro 129beon-gil, Juchon-myeon,
Gimhae-si, Gyeongsangnam-do, South Korea (50969)

DK-Lok contact information

Tel. (82) 55-338-0114

Fax. (82) 55-901-0143

E-mail : sales@dklok.com

For International customers

Tel. (82) 55-338-0031/2

Fax. (82) 55-901-0142

E-mail : dklok@dklok.com